

For Product Step File or 3D Model Send a Request Mail To info@nrack.com



Photo View

MS 609-1-1



MS 609-1-2



MS 609-1-1

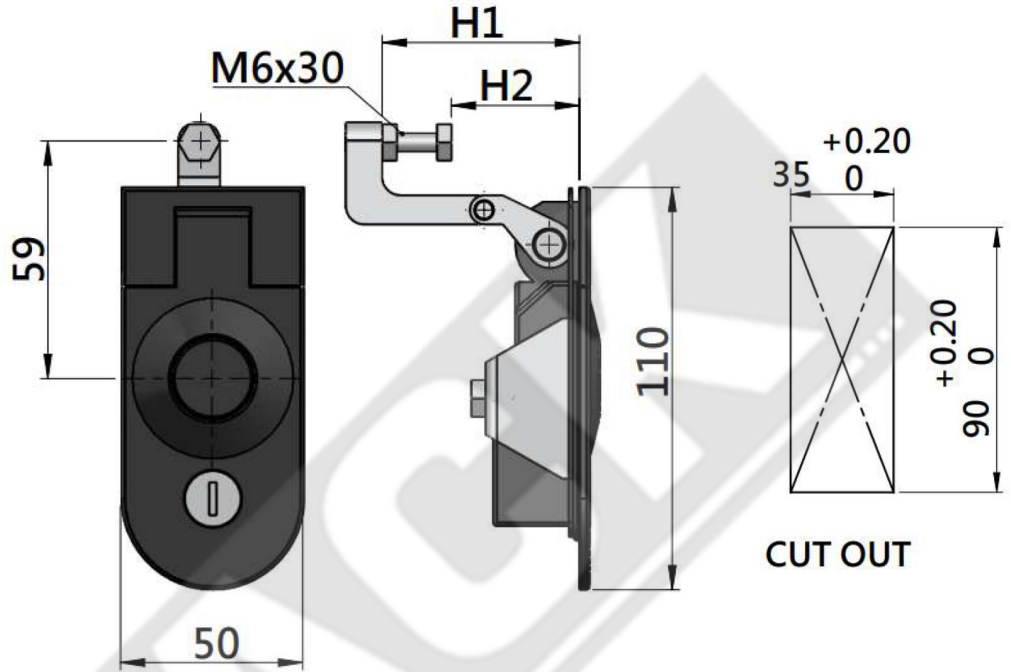

MS 609-1-2

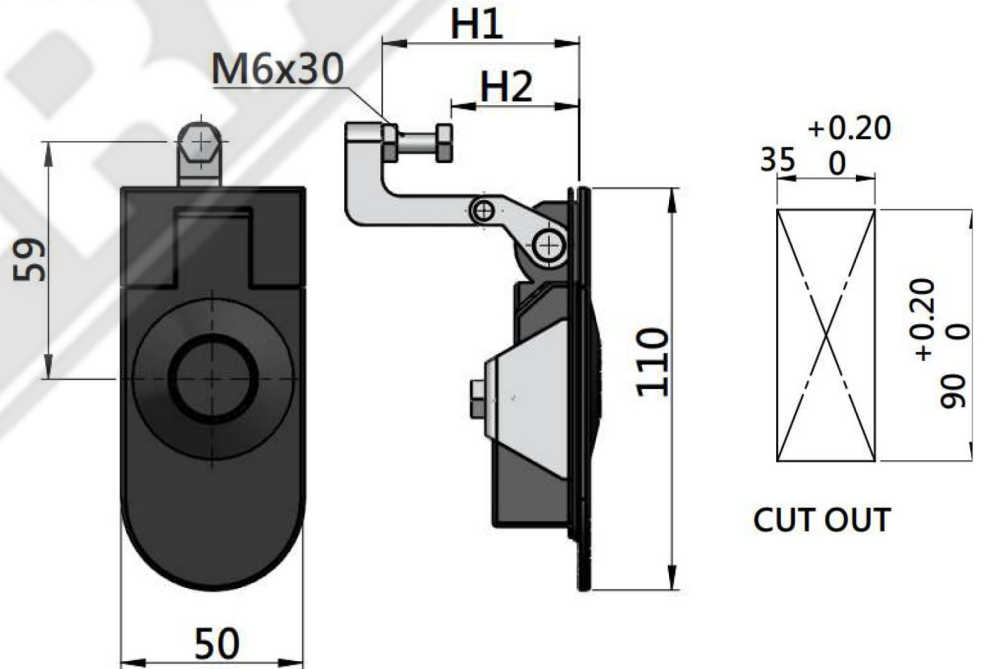

MS 609

- Material: Zinc die-casting
- Finish: Black powder coated
- Panel thickness: 1~5mm

Dimensions		Product Number					
H1	H2	With key	Weight (g)	Lot	w/o key	Weight (g)	Lot
21	0- 15	MS 609- 1- 1	357	50	MS 609- 1- 2	350	50
52	30- 45	MS 609- 1A- 1	357	50	MS 609- 1A- 2	350	50
67	45- 60	MS 609- 1B- 1	357	50	MS 609- 1B- 2	350	50
35	15- 30	MS 609- 1D- 1	357	50	MS 609- 1D- 2	350	50